

# ARCHITECTURAL DESIGN

## MEASURING CUP

### STEPS TO USE

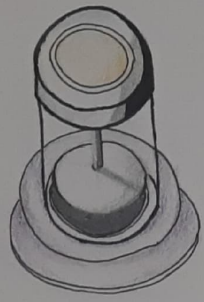

MEASURING CUP VIEW



LID TOP VIEW

PRESS TO OPEN



STEP 1:  
FIX THE MEASURING CUP ON THE BOTTLE NECK

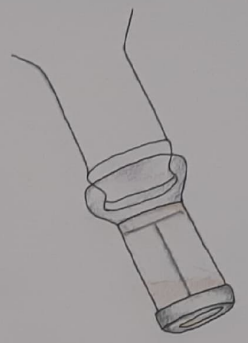

STEP 2:  
TURN THE BOTTLE UPSIDE DOWN, AND FILL THE 30ml CUP



STEP 3:  
PRESS IN THE CENTER OF THE CAP TO POUR IT INTO A GLASS

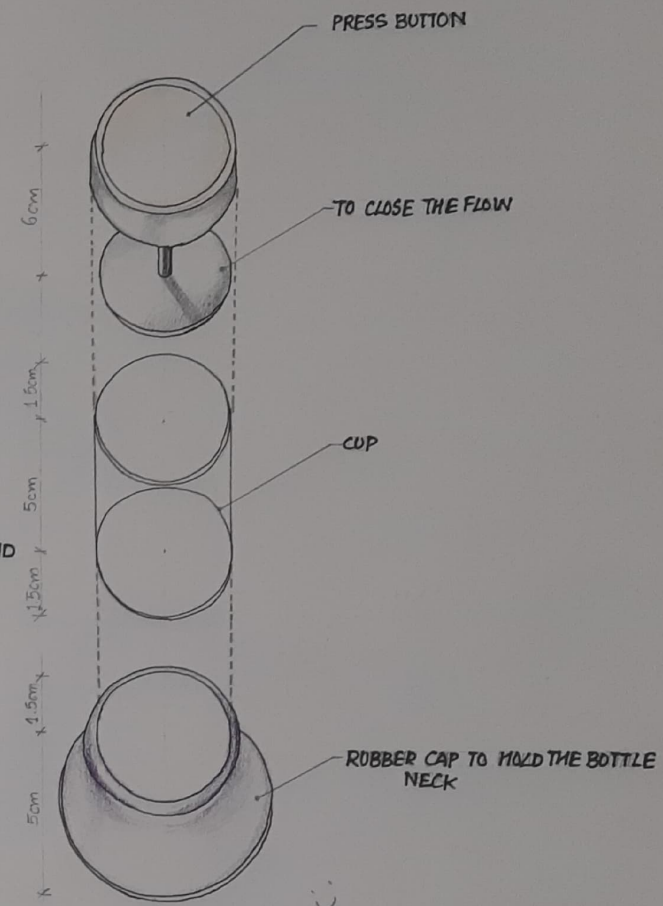

SCALE: 1:1

### CAN BE USED FOR DIFFERENT LID TYPES

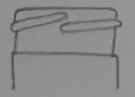

DIA: 25mm  
HEIGHT: 15mm  
1 THRED TURN



DIA: 25mm  
HEIGHT: 20mm  
1.5 THRED TURNS



DIA: 30mm  
HEIGHT: 40mm  
2 THRED TURNS



DIA: 20mm  
HEIGHT: 15mm  
2 THRED TURNS



DIA: 30mm  
HEIGHT: 27mm  
1 THRED TURN



DIA: 35mm  
HEIGHT: 20mm  
NON-CONTINUOUS THREDS

RV COLLEGE OF ARCHITECTURE  
Class Teacher:  
(Signature with Date)  
B. Arch / 1st Arch Exam

# UNNECESSARY INVENTIONS

MAPPING THE COMIC

OBJECTIVE OF THE EXERCISE

IN THIS EXERCISE WE HAD TO READ ANY COMIC BOOK AND UNDERSTAND THE CONTENT AND THE SET OR WHERE ITS PLACED. THEN MAKE A MAP OF THE ENTIRE SET IN A NEWSPAPER.

THEME OF THE STORY

THIS STORY WAS TAKEN FROM THE STORY BOOK CALLED 'TWINKLE'. THE STORY TALKS ABOUT A GREEDY PERSON, WHO, BECAUSE OF HIS GREED TRAVELS TO MANY PLACES TO BUY A COCONUT FOR A LOW PRICE. BUT ENDS UP HURTING HIMSELF AND PALYING A LOT OF MONEY ON HIS TREATMENT.

MORAL OF THE STORY

NEVER FOR GREEDNESS GO BEHIND SOMETHING TO SAVE ONES MONEY, YOU NEVER KNOW WHAT IS IN YOUR FUTURE.

ALL FOR A COCONUT

Have clean mobility solutions reached contro stage? Now open for public comments, the policy could not have come at a more opportune moment. First, because of the... The battery swapping policy could not be more opportune... The economics of Baas... The swapping policy has the potential to... The swapping policy has the potential to... The swapping policy has the potential to...

...important for India to be on its guard. Therefore, it's important for governments to double down on public health... Australia and Germany among others, have a higher vaccination coverage ratio. While vaccination limits the severity of disease, it does not prevent infection... Around 138 million vaccines with similar challenge posed by the rapid rollout... It's a necessary hurdle to overcome as compared to... critical... no Covid-19... shown that... a vaccine, is... booster... to... also... Keep the...

Comic strip panels: Gilbert, Why didn't you talk to me before making this decision?, I left you a voice-mail, an email, and a text message., I also messaged you on Skype, WhatsApp, Twitter and Facebook., I did you know I left a note on your door., I am besides thee. O servant, where dost thou seek Me? I am beside thee. I am neither in temple nor in mosque. I am neither in Kaaba nor in Ganga. thou art a true seeker - and shalt meet me in a moment of time. Kabir says, O Saad, is the breath of the universe.

Really Presented By Vasishth of Prithvi Vakra. Narayan Ganesh. any commentaries been written on the two wisdom works, one by Sage Vasishth in conversation with Prithvi Ram, and the other by Sage Ashtavakra, answering a quest posed to him by King to the sound of the Ramayana and the Mahabharata. Where the forest grows, all grow. In pursuit of the dream you lost. 'The Dreamer', the many lyrical conditions that take one through the way to the beyond, offering... THE SPEAKING TREE. In the process, we are led to a wonderfully expressive meditation on subjects we dread. The works of both Vasishth and Ashvakra are...

Pool NRI relative. Once she was a star, by means of fortune (and) competence of a family. In the end, she was a... On one of the wonders of India was the NRI relative. Like the exotic migratory birds that alighted at Alipon Zoo, they flew in thousands of milk and honey and carried with them warm dozers, memorable tales of the great 'p' and wondrous appendages like a camcorder, a DSLR camera, and other things we did not know that the human had invented. Even though he hardly ever met these people, we knew no one loved us the way they did, and that's why they opened their Samsonite suitcases and began to pour branches into the inner recesses of his heart. Chocolates (always labelled as Swiss), cheese, wine, perfumes, adult beverages, and make-up kits and perfume... of ever-age group and gender, the value of our... 'atives' distances from you in the family tree... use that presented our... you had to do... an NRI relative come to India... Not any more. Nowadays, NRI relatives are... themselves when they go to India. No more... trinkets as 'electronic'... now thanks to the internet... Dr Singh's liberalisation every... thing is available in India. Forget... their tales of fortune and opulence be called... they carry and what they bring as gifts. Fish out your... Indian nepotism are two models ahead. Talk about brand... the stores being there in the neighbourhood mall, they... out that you are pronouncing the brand name wrong. Br... choleza, only to hear 'but uncle we already have our fridge overloading with them.' This is why I never liked Adam Smith. The free movement of goods and information that globalisation has brought about has knocked the hub from the heads of NRI relatives and made it difficult, much more difficult, to hook yourself into the memories of those you rarely meet.

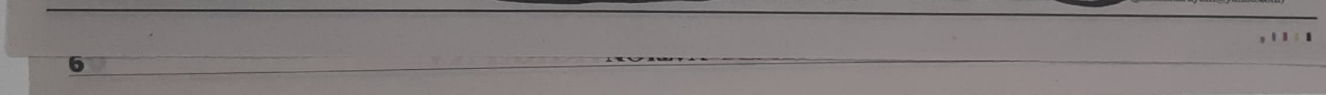

COMIC INTERPRETATIONS



ARCHITECTURAL  
DESIGN

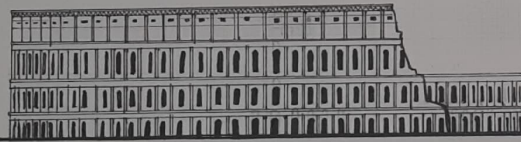

GROUND LINE

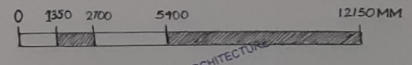
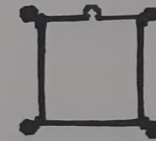
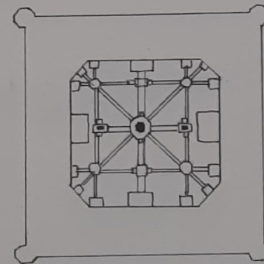
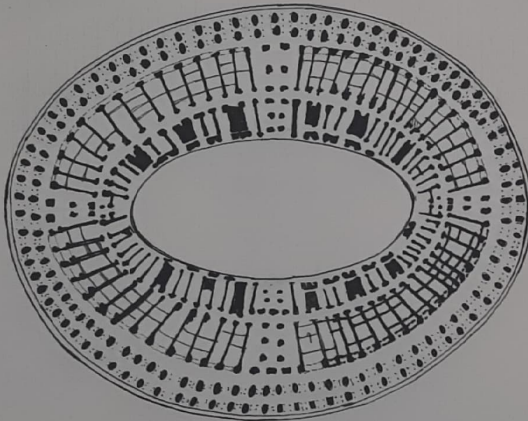
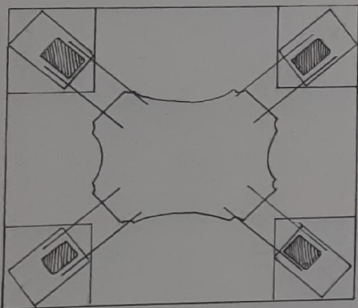

*Handwritten signature*  
B

SCALE AND PROPORTION

# ARCHITECTURAL DESIGN

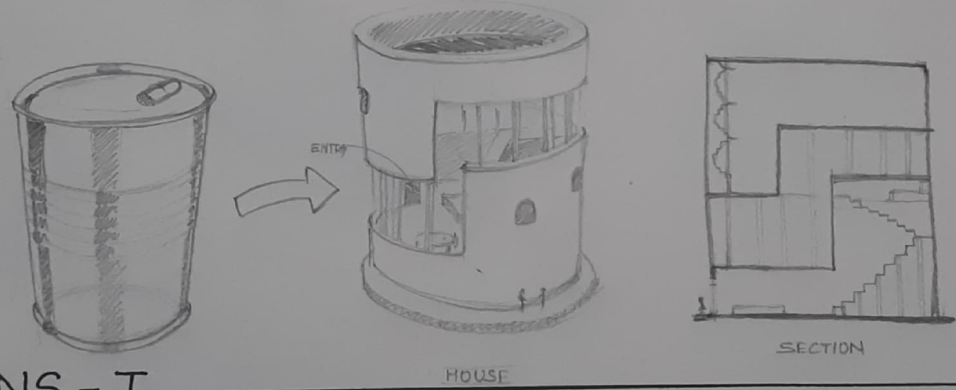
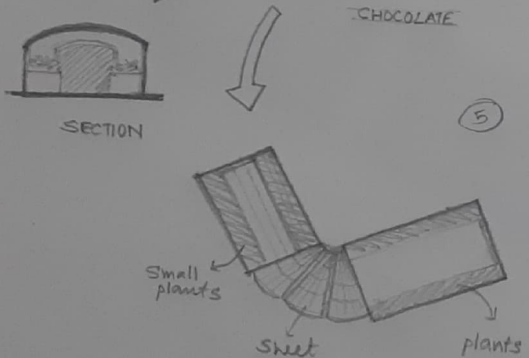
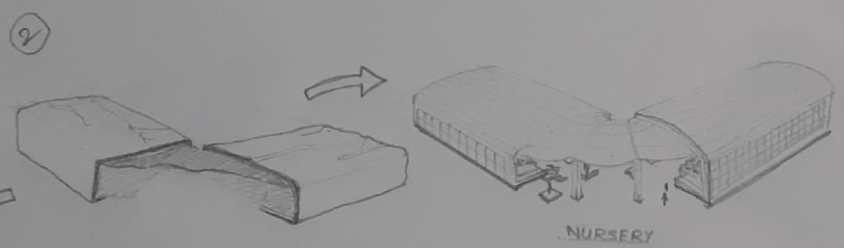
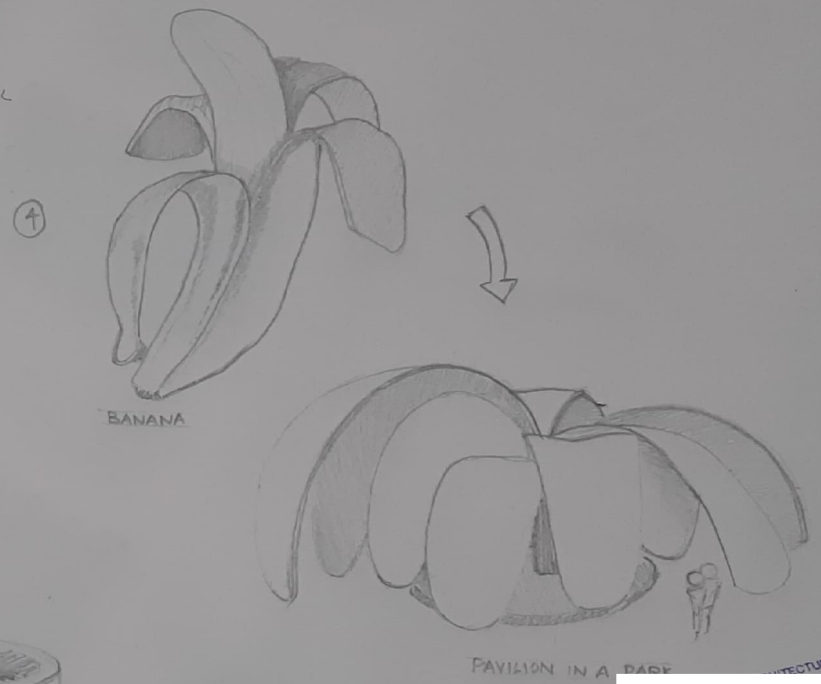
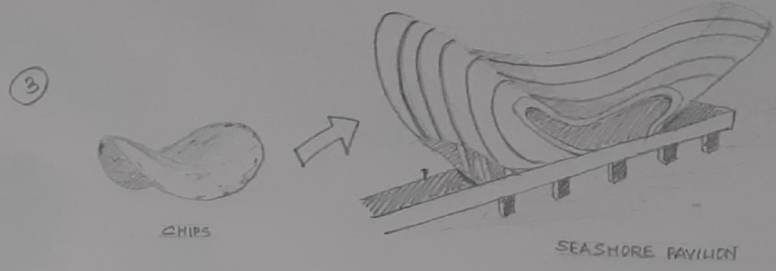
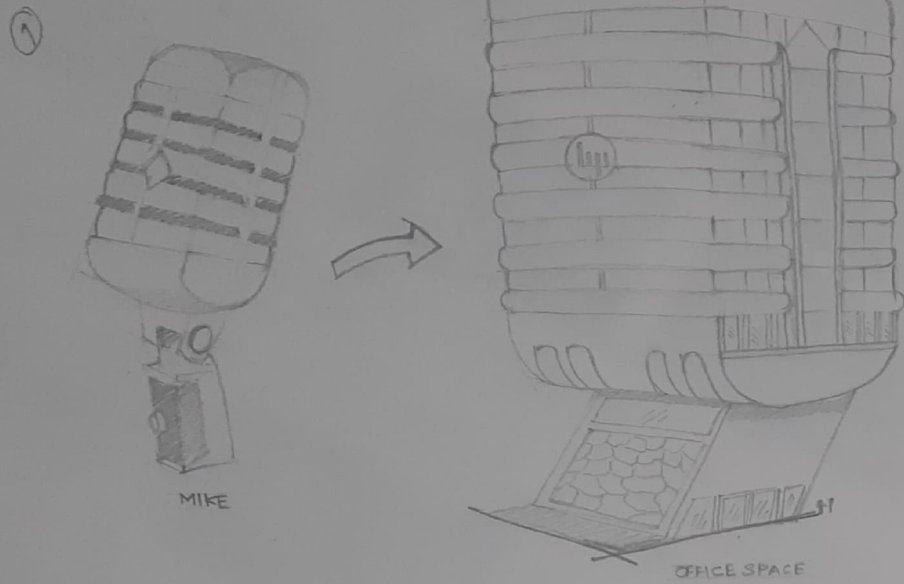

ITERATIONS - I



# ARCHITECTURAL DESIGN

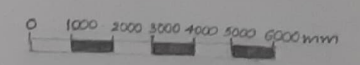
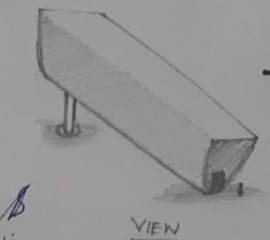
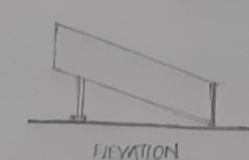
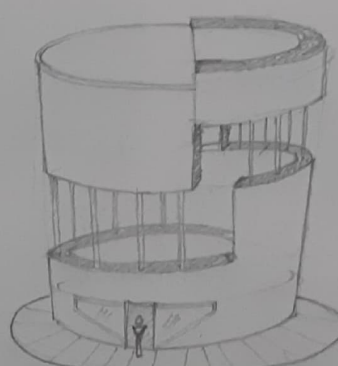
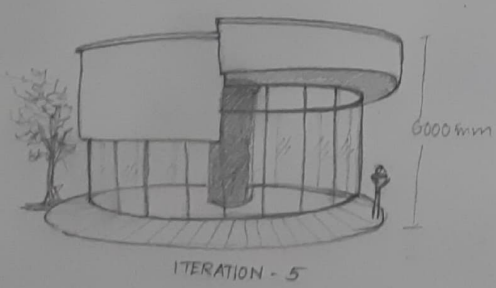
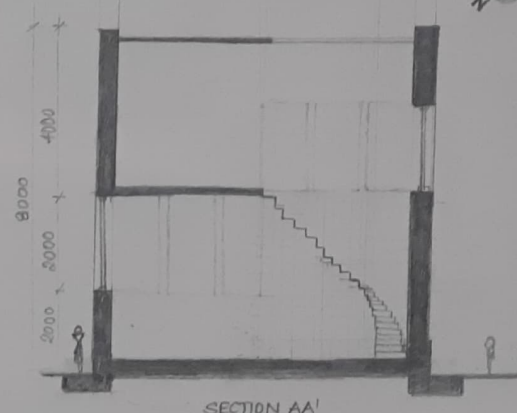
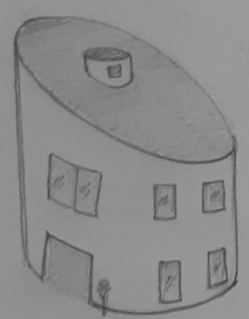
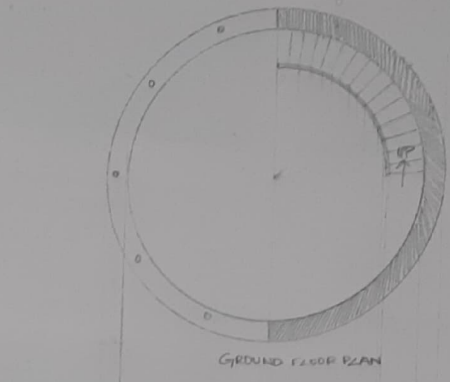
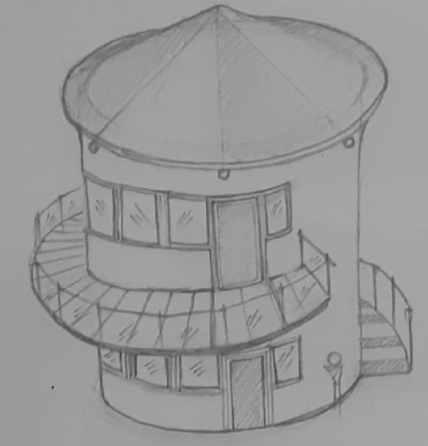
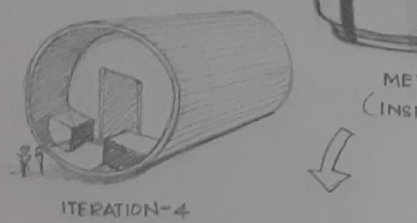
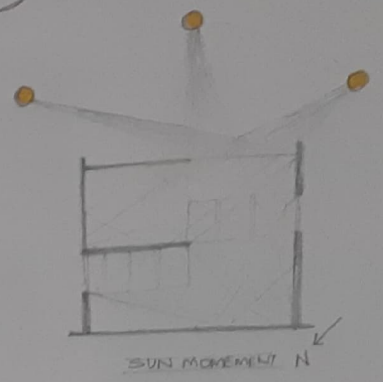
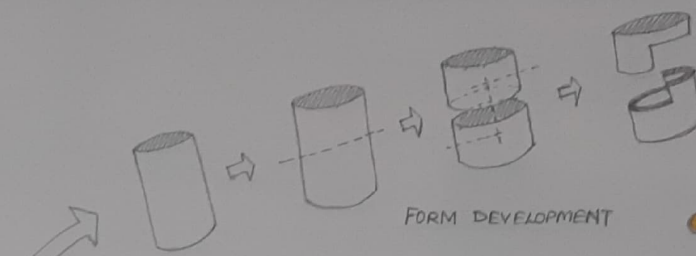
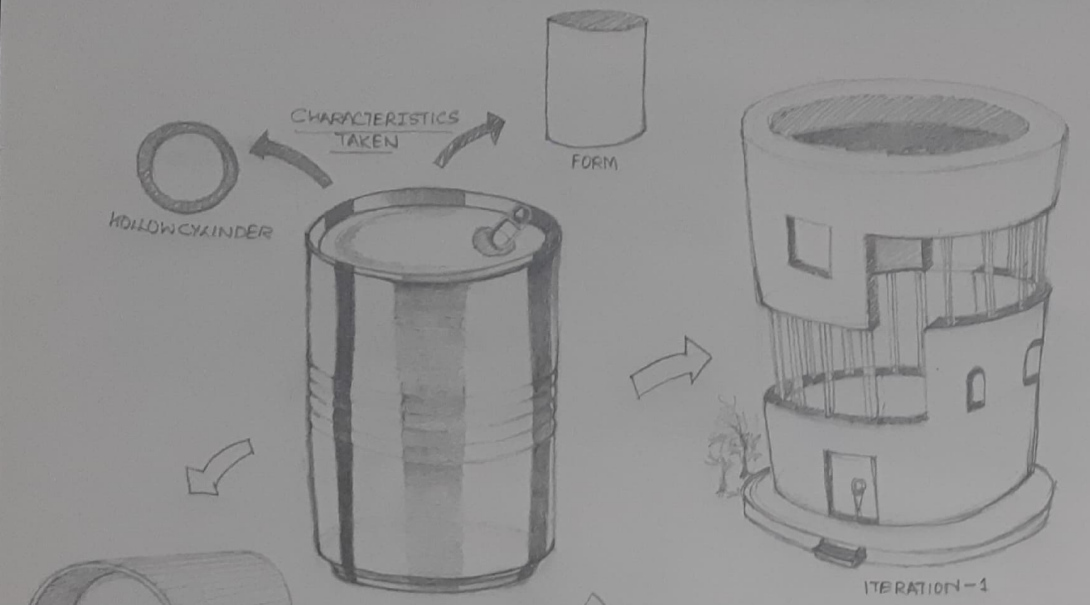

## GALLERY TIME AND SPACE

(THE GUILD, 2<sup>ND</sup> FLOOR, #55 LAVELLE ROAD, BANGALORE-560001)

- ESTABLISHED: 1998 (25 years)
- OWNED BY: MRS. KENN GEORGE
- MAINLY MASTER ARTISTS AND OTHER COLLECTIONS ARE DISPLAYED



IMAGE - 1

- THE WALLS AND PAINTS WERE PAINTING IN WHITE, TO BRING OUT THE PAINTING COLOUR, AND AN CONTRASTING DARK BLACK CEILING.



IMAGE - 2



IMAGE - 3



IMAGE - 4

- NORMAL BRICK WALLS, WITH ONE OF THE WALL EXPOSED.
- RECTANGULAR PLAN, WHERE AROUND 30 - 40 PAINTINGS AND COLLECTIONS WERE DISPLAYED

### INTERIOR PLAN



- USED SPOTLIGHT LIGHTS AND SPREAD LIGHT IN MINIMUM INTENSITY TO GIVE IT A GOOD AESTHETIC ASPECT.
- VERY LESS NATURAL LIGHT THAT WAS THERE MOST OF IT WAS ARTIFICIAL LIGHTS.



IMAGE - 5



IMAGE - 6



IMAGE - 7



IMAGE - 8

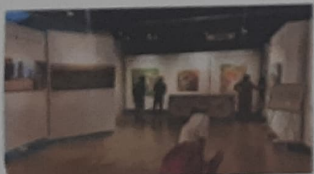

IMAGE - 9



IMAGE - 10



IMAGE - 11

## MKE MUSEUM OF ART

(55/1, LAVELLE ROAD, OPPOSITE TO GODABOTTLE OF ENERJALA HOTEL SHANTHALA NAGAR, BANGALURU-560001)

- ESTABLISHED 2018 (4 years)
- OWNED BY MANUSHI (INTERIOR DESIGNER)
- MAINLY COLLECTIONS AND PAINTINGS OF MANUSHI ONLY WAS DISPLAYED.



IMAGE - 1

- HER PAINTINGS SPOKE ABOUT - HER FEELINGS, LIFE
- USE OF ORGANIC SHAPES
- MOSTLY COMPLIMENTARY TYPE
- PHILOSOPHICAL WORK.



IMAGE - 2



IMAGE - 3



IMAGE - 4

- RECTANGULAR PLAN WAS SEEN.
- BRICK WALLS AND USE OF PANALS.
- GOOD LIGHTING, COLOUR PALATE OF BROWN AND WHITE WAS USED.
- GOOD SENSE OF SMELL WAS MAINTAINED.

- VERY GOOD AESTHETICS WAS THERE, WITH THE LIGHT AND SOUND AND SMELL.

- THE PAINTINGS WERE KEPT AT AN HEIGHT OF 140 - 150 CM FROM GROUND, SO THAT THE EYE LEVEL OF THE PERSON STANDING FALLS ON THE CENTER OF THE PAINTING.

### GALLERY PLAN



IMAGE - 5



IMAGE - 6



IMAGE - 7



IMAGE - 8



IMAGE - 9

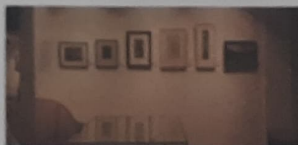
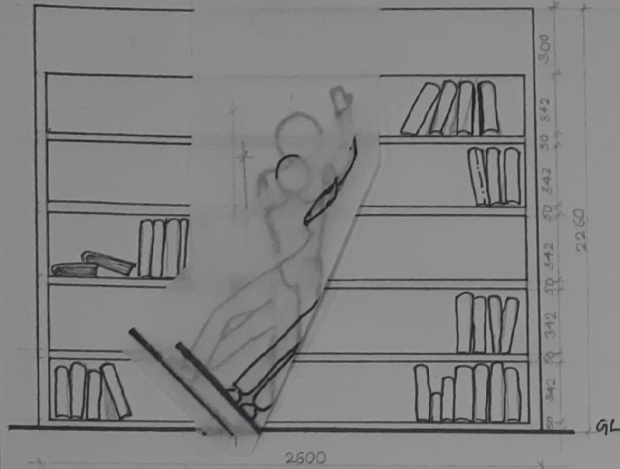
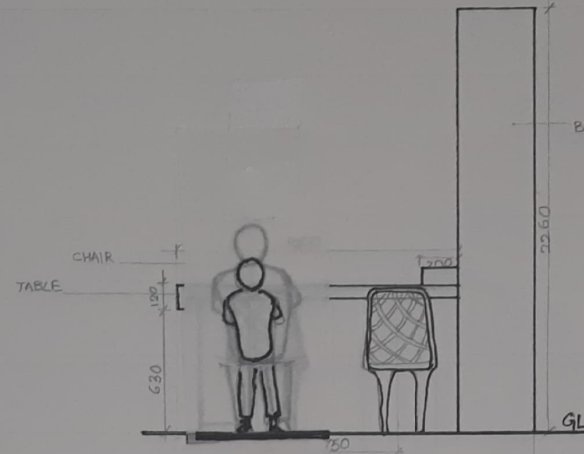

IMAGE - 10



FRONT ELEVATION OF BOOK SHELF SCALE: 1:20



SIDE ELEVATION SCALE: 1:20

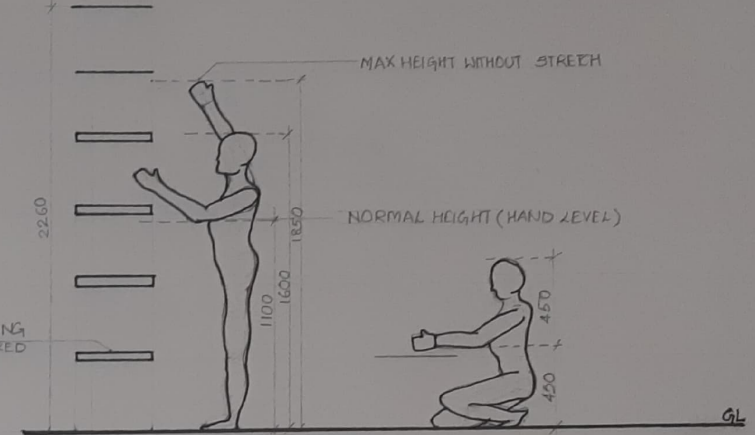

ANTHROPOMETRY OF THE SHELF SCALE: 1:20

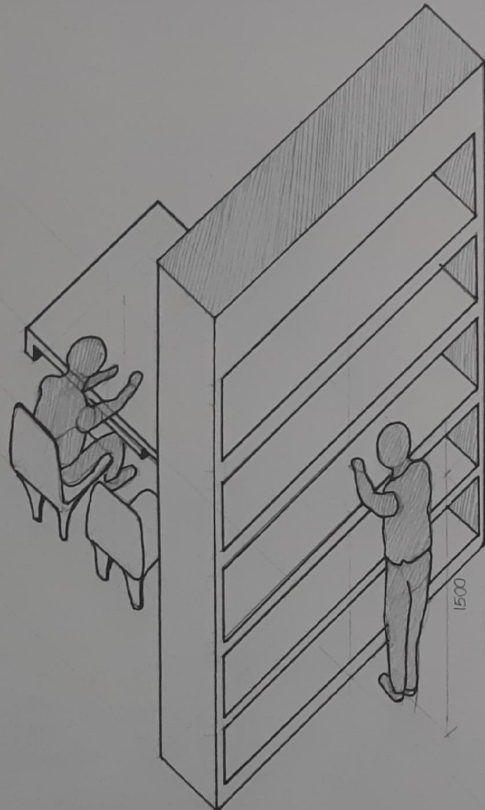

AXONOMETRY VIEW SCALE: 1:20

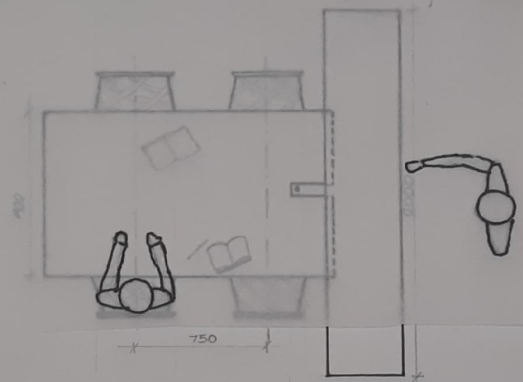

TOP VIEW SCALE: 1:20

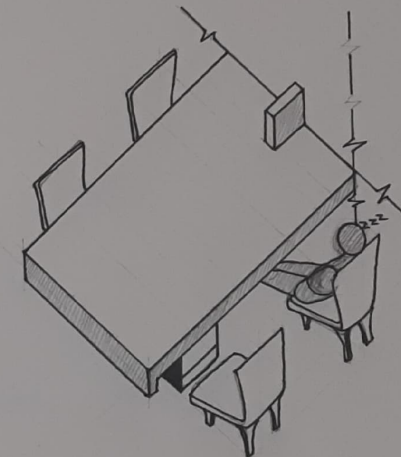

AXONOMETRY VIEW OF TABLE SCALE: 1:20

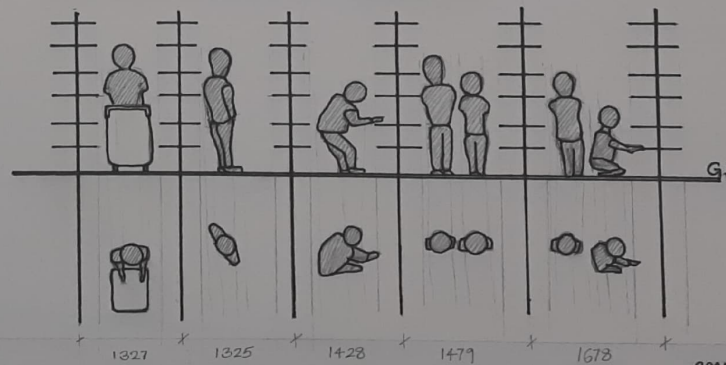

SPACES BETWEEN SHELVES SCALE: 1:50

ANTHROPOMETRY

OF ARCHITECTURE

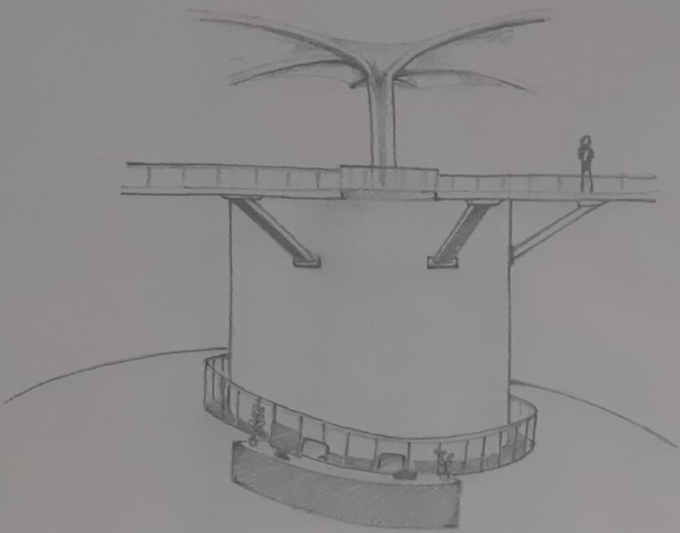

FRONT VIEW

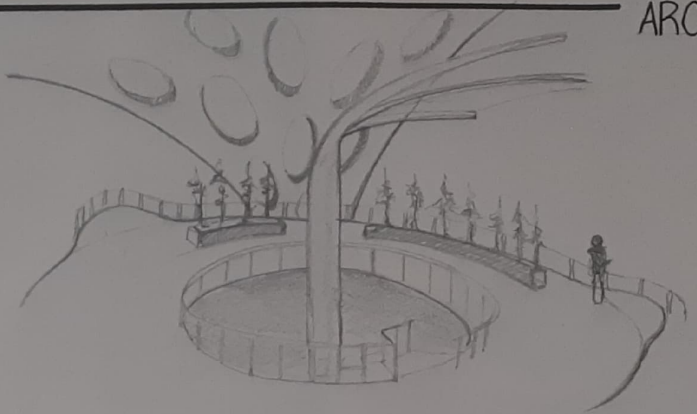

TOP FLOOR VIEW

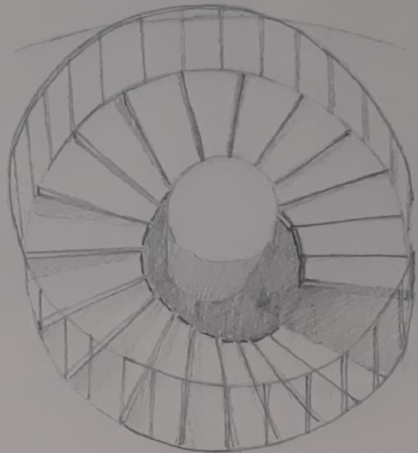

STAIRS FROM TOP FLOOR VIEW

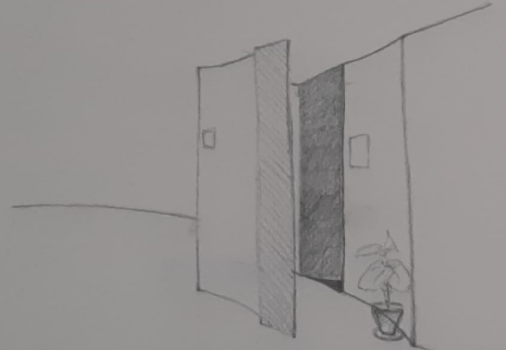

BATHROOM OUTSIDE VIEW



CANTEEN VIEW

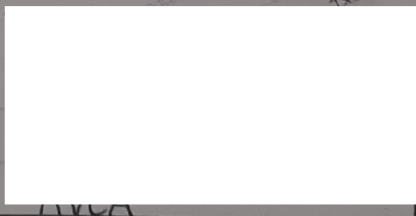



SITE SURVEY REPORT

LOCATION: PUTHUVYPE BEACH KOCHI KERALA INDIA

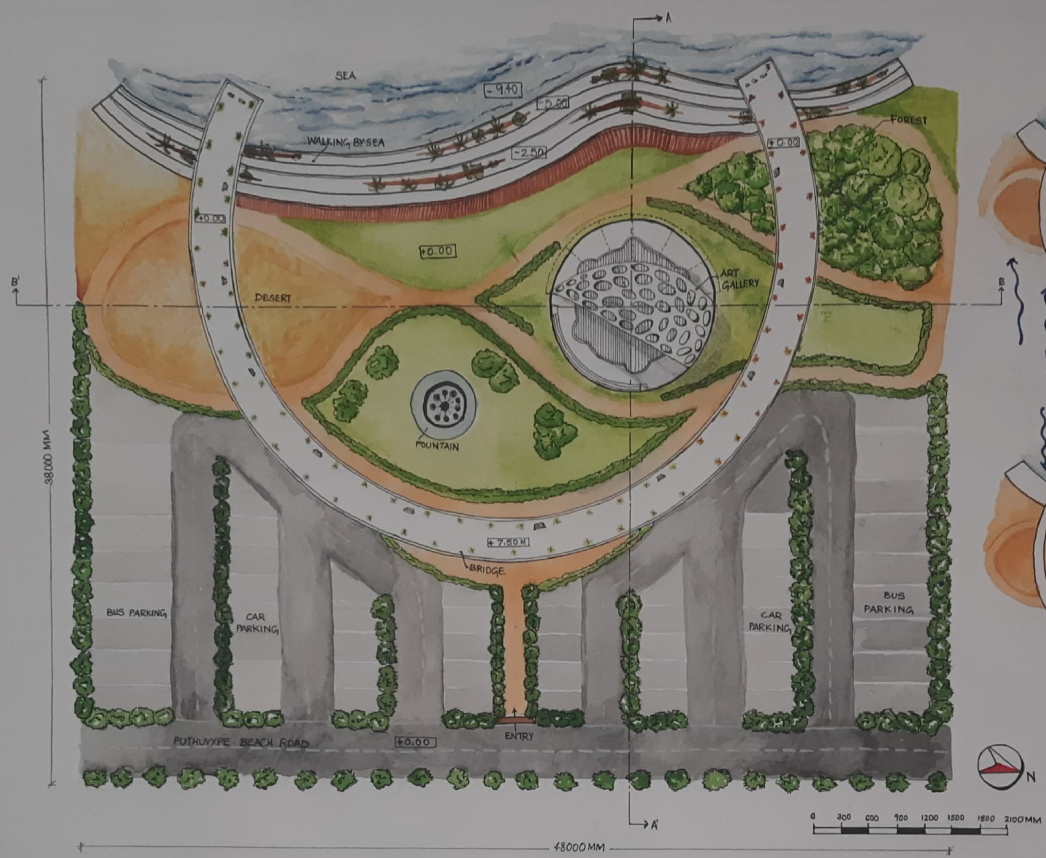

WIND DIRECTION ANALYSIS

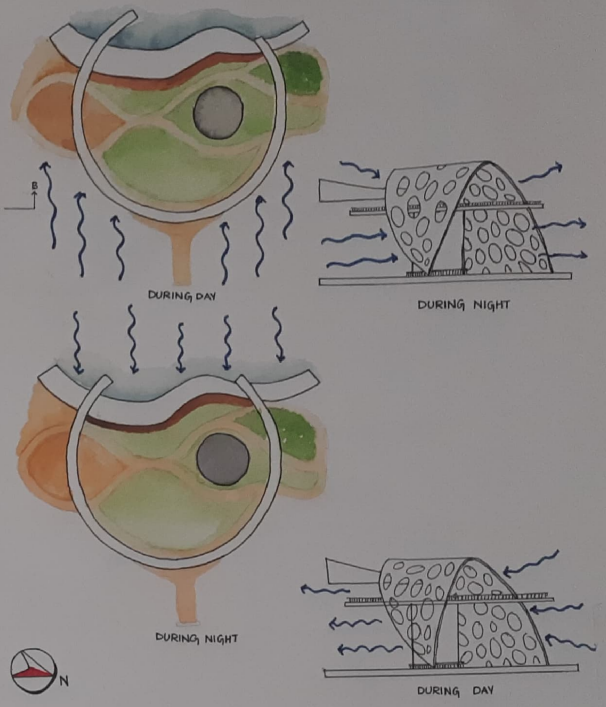

SITE PLAN

MATERIALS USED IN THE GALLERY

SL. NO.	COMPONENTS	MATERIAL
1.	PLINTH/GROUND FLOOR	CONCRETE [POLISHED FINISH]
2.	COLUMN	CONCRETE [POLISHED FINISH]
3.	STAIRS	WOODEN TREAD
4.	CENTER POLE	STEEL ROD
5.	SECOND FLOOR	STEEL [BOX SECTION]
6.	DOME	GFRG [GLASS FIBER REINFORCED CONCRETE]
7.	ROOF	THIN LEAF SHEETS.



SITE SECTION BB'

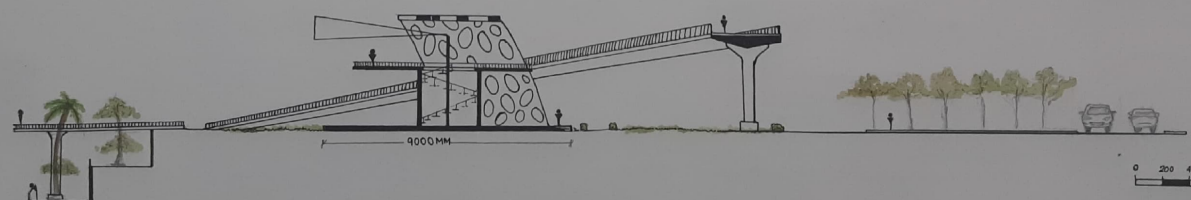

SITE SECTION AA'

SUN DIRECTION

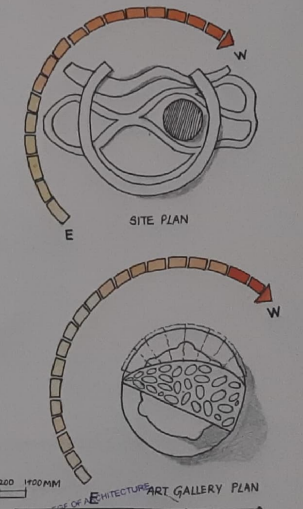

ART GALLERY PLAN

ART GALLERY

THEME: NATURE

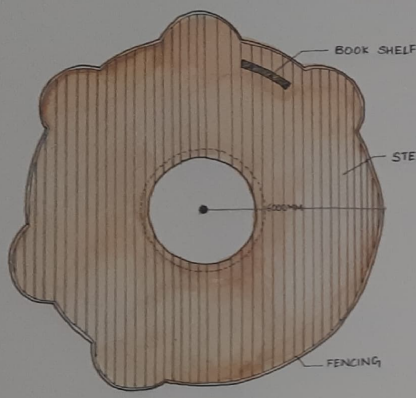

FIRST FLOOR PLAN

TOTAL AREA  
RADIUS OF PLAN - 9m  
AREA - 254.34 sqm

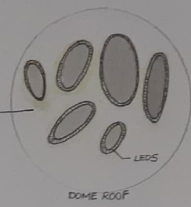
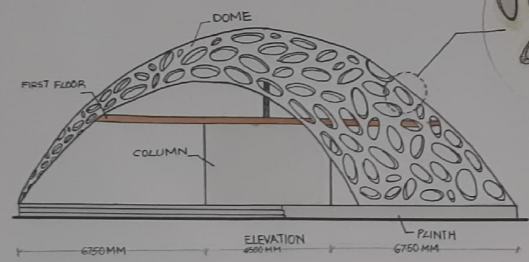

DOME ROOF  
LED DIM AND BRIGHT LIGHTS AROUND THE CIRCUMFERENCE OF THE HOLES.

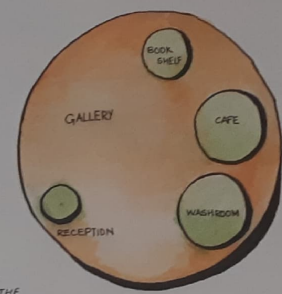

BUBBLE DIAGRAM

REQUIREMENTS FOR A ART GALLERY

- GALLERY SPACE
- WASHROOM
- CAFE
- RECEPTION
- BOOK SHELF



DESIGNING OF THE ART GALLERY

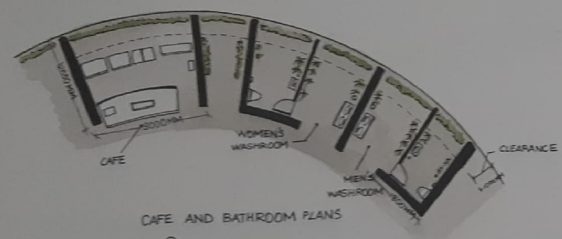
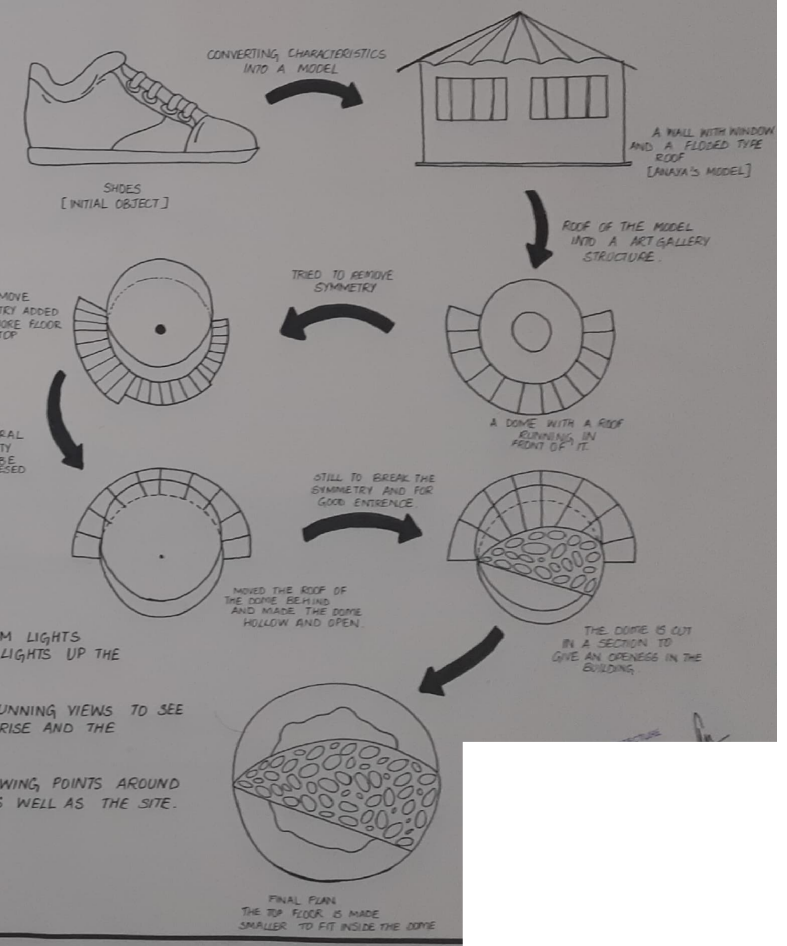

CAFE AND BATHROOM PLANS

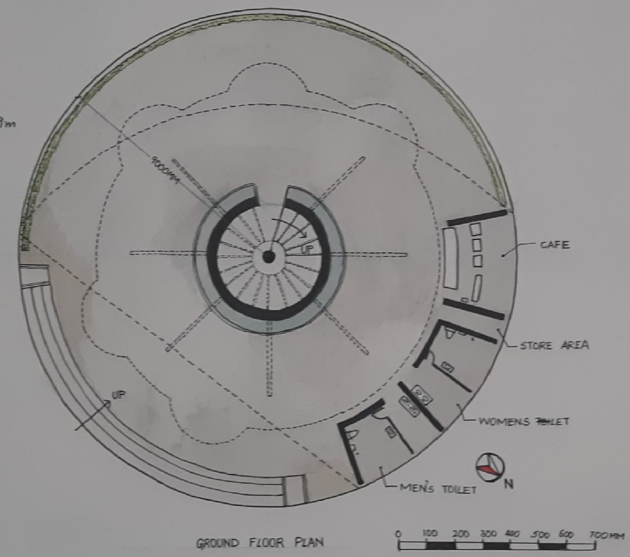
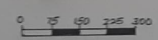

GROUND FLOOR PLAN

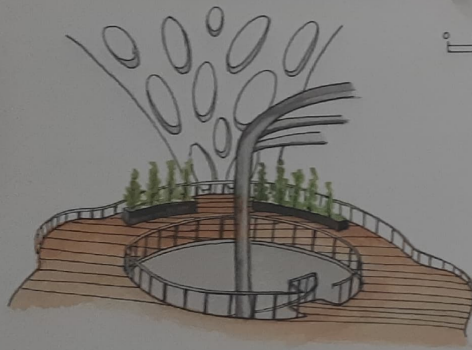

PERSPECTIVE OF THE FIRST FLOOR

SOMETHING ABOUT THE PLACE

- \* THIS ART GALLERY SIGNIFIES "NATURE" AND SHOWS ALL THE ASPECTS OF NATURE.
- \* IN THIS GALLERY WE SHOWCASE MAINLY OF PLANTS, FOSSILS, ROCKS, ANTIQUE PIECES.
- \* THE SITE OF THIS ART GALLERY IS DESIGNED TO SHOW ALMOST ALL THE BASIC TERRAINS IN NATURE, LIKE DESERTS, SEA (WATER), FOREST, NATURAL GREEN LAND, MOUNTAIN STEPS.
- \* AT NIGHT THE DIM LIGHTS FROM THE DOME LIGHTS UP THE PLACE.
- \* THE SITE HAS STUNNING VIEWS TO SEE THE MORNING SUN RISE AND THE EVENING SUN SET.
- \* THERE ARE VIEWING POINTS AROUND THE BUILDING, AS WELL AS THE SITE.

Ananya's Model

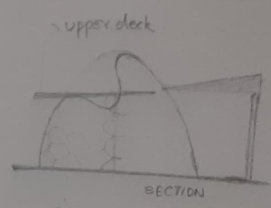
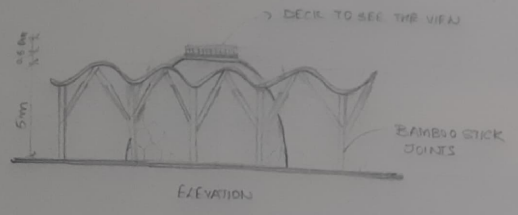
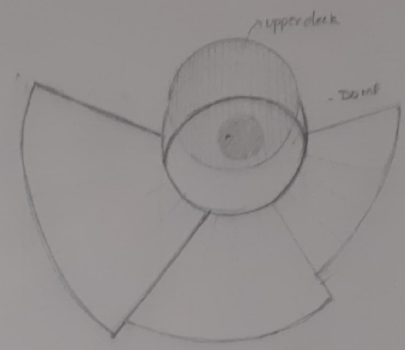
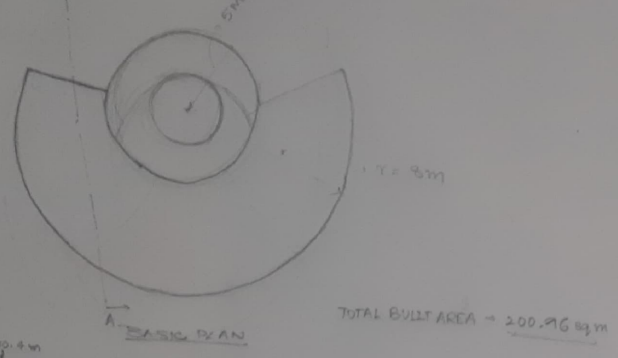
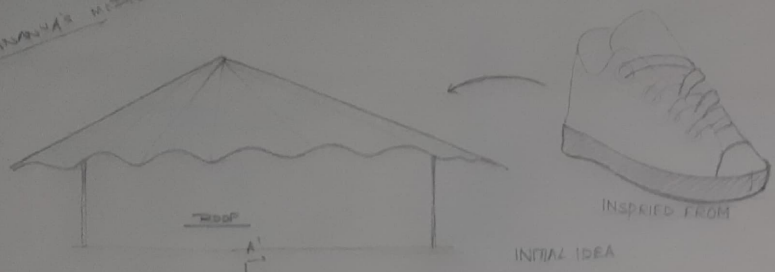

ITERATION - 1

ITERATION - 2

PROCESS

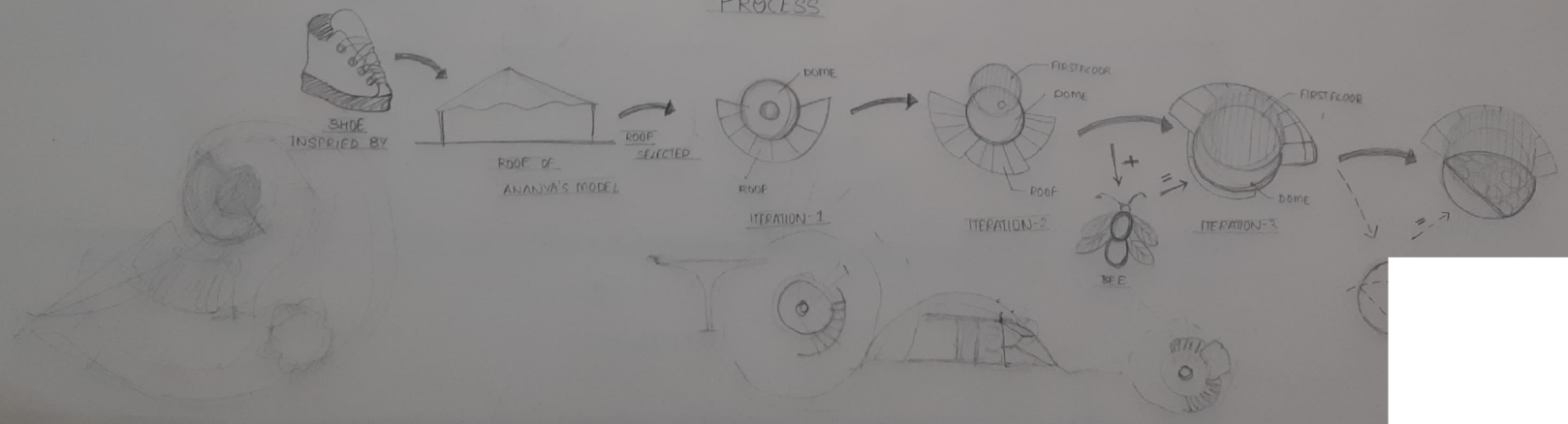

# ART GALLERY DESIGN

## THEME: NATURE

- REQUIREMENTS FOR A ART GALLERY
    - \* GALLERY
    - \* RECEPTION / SECURITY
    - \* TOILET
    - \* CAFE
    - \* BOOK SPACE
- BIGGER  
 SIZE / AREA  
 SMALLER

### BUBBLE DIAGRAM

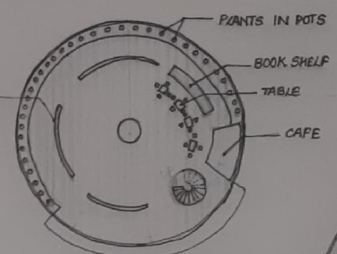
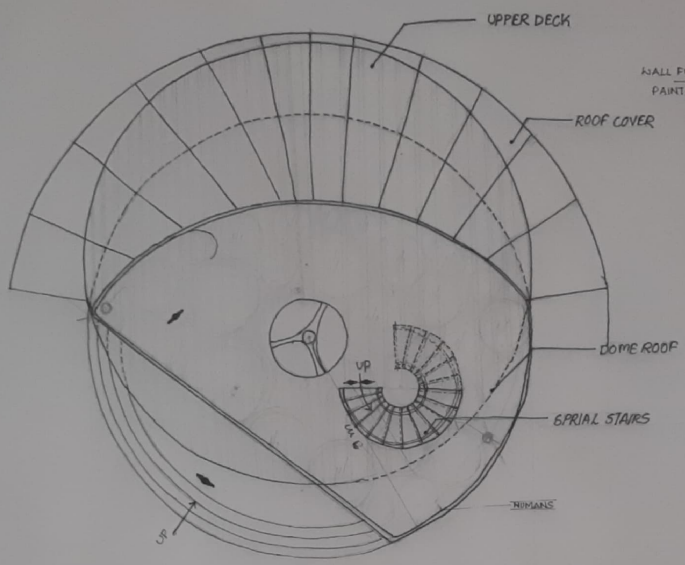
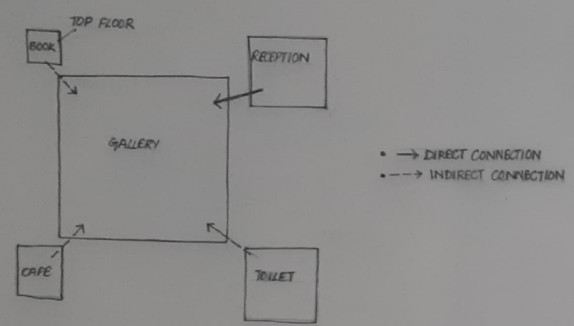

FIRST FLOOR PLAN  
SCALE: 1:200

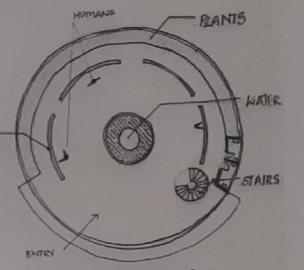

GROUND FLOOR PLAN  
SCALE: 1:200

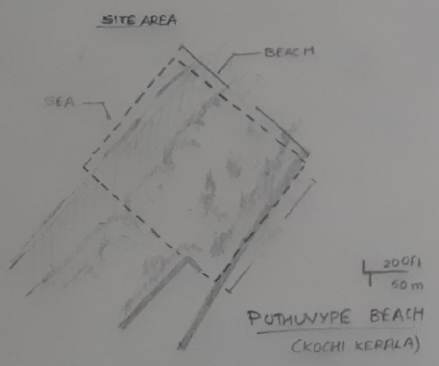

PUTHUVYPE BEACH  
(KOCCHI KERALA)

AREA CALCULATION  
 $r = 9\text{ m}$   
 $\pi r^2 = 254.34\text{ sq. m. of BUILT AREA}$

PLAN SCALE: 1:300

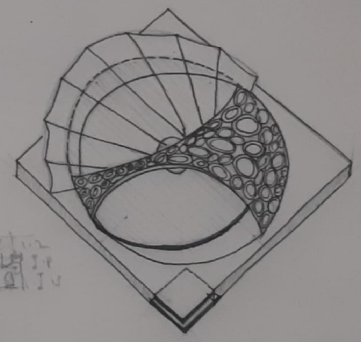
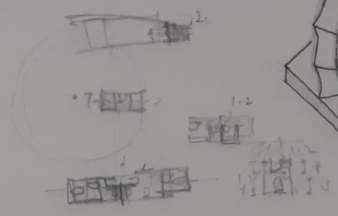

ISOMETRIC VIEW SCALE: 1:200

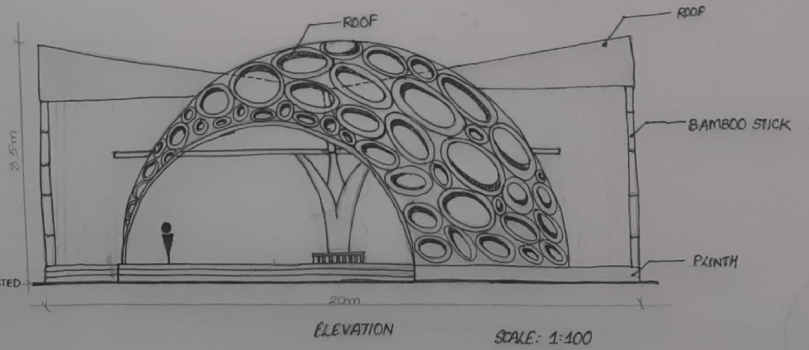
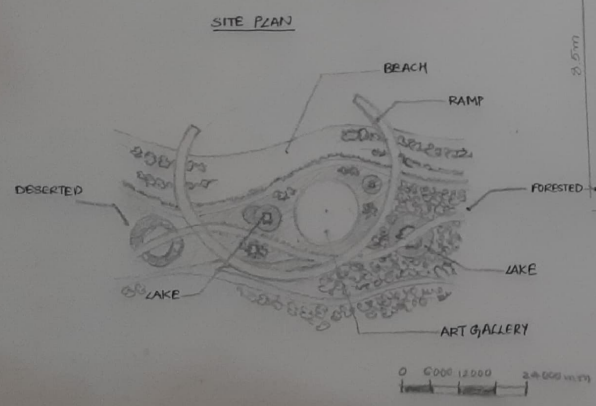

# ART GALLERY DESIGN-II

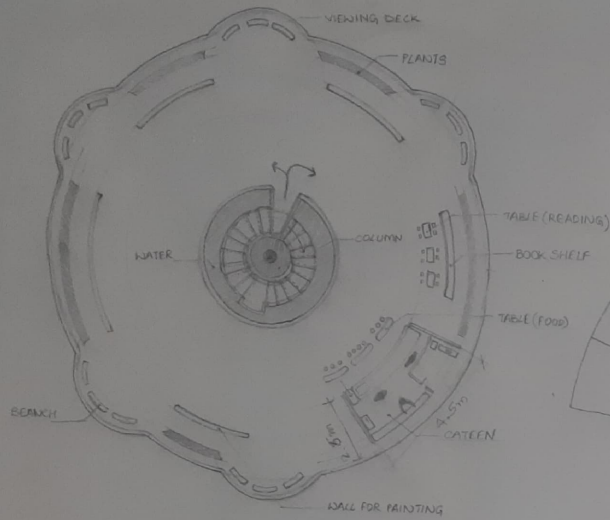

FIRST FLOOR PLAN SCALE: 1:100

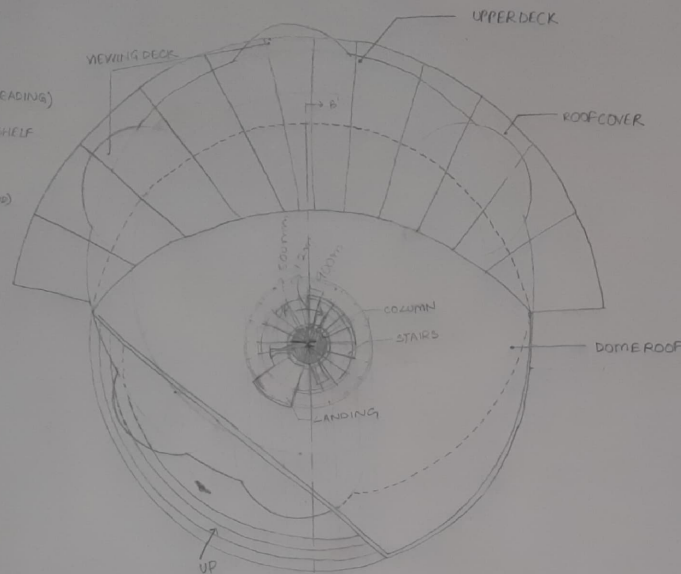

AREA CALCULATION PLAN SCALE: 1:100

$R = 9m$   
 $\pi r^2 = 254.34 \text{ sq.m of BUILT AREA}$

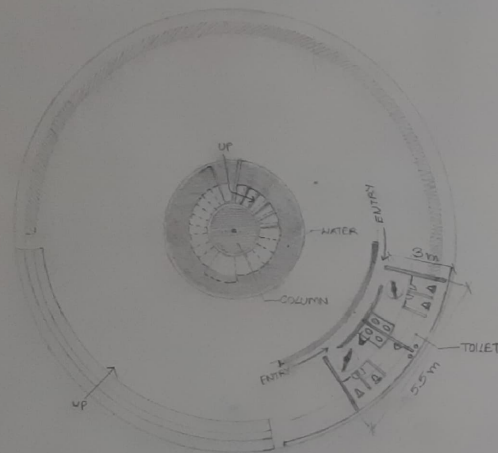

GROUND FLOOR PLAN SCALE: 1:100

## MATERIALS THAT ARE REQUIRED

- \* DOME: STEEL - PRECASTED (READYMADE)
- \* PLINTH: CONCRETE - TOP SURFACE SALT FINISH.
- \* TOP FLOOR: STEEL BARS WOOD FINISH

\* PILLER: FOR ROOF: BAMBOO

\* ROOF:

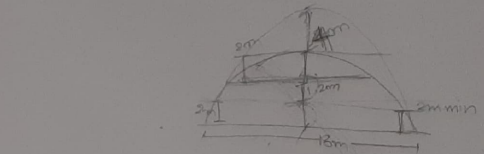

## WASHROOM DETAILS

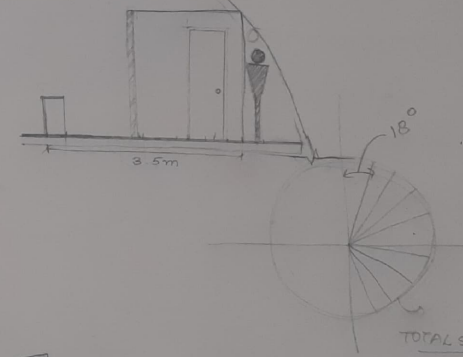
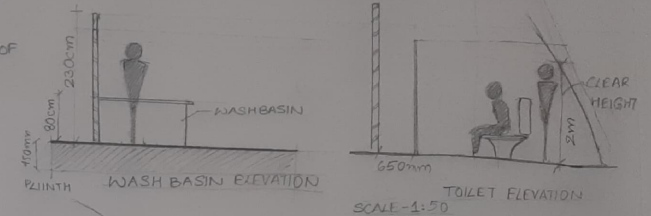

TOTAL STAIRS - 20 steps

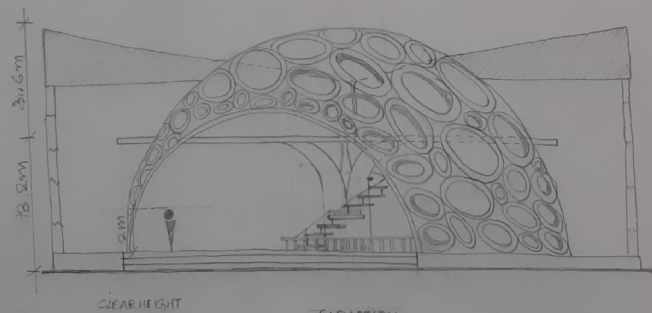

CLEAR HEIGHT ELEVATION SCALE: 1:100

## TOILET DETAILS

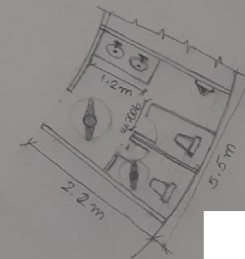

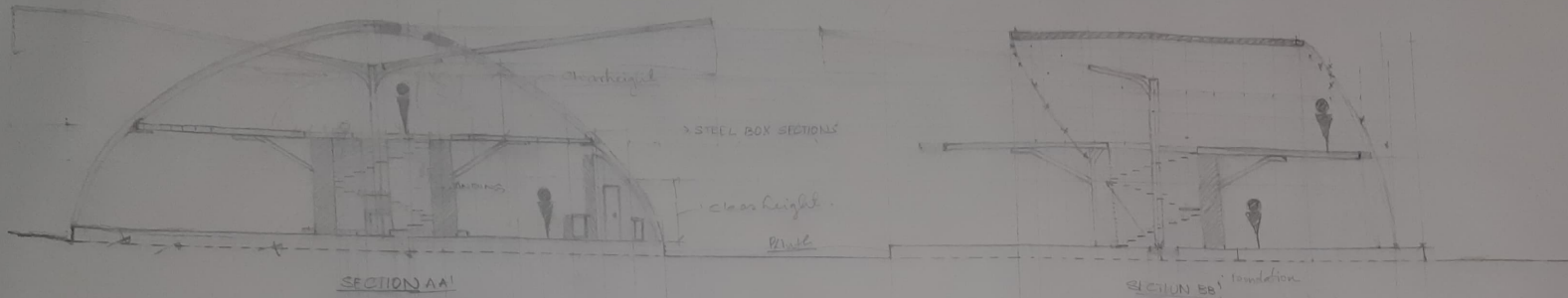

12m ± 18000mm  
 18000 - 245  
 0.64 per pod 19215kg/m

ISSUE  
 Rain Control

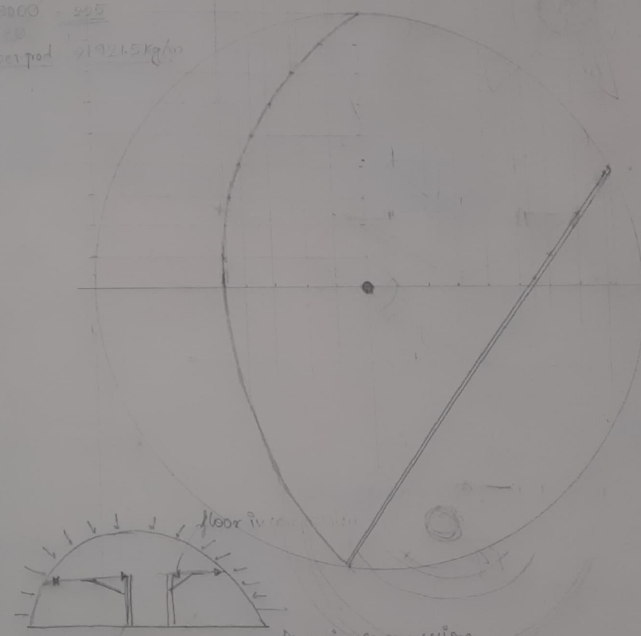
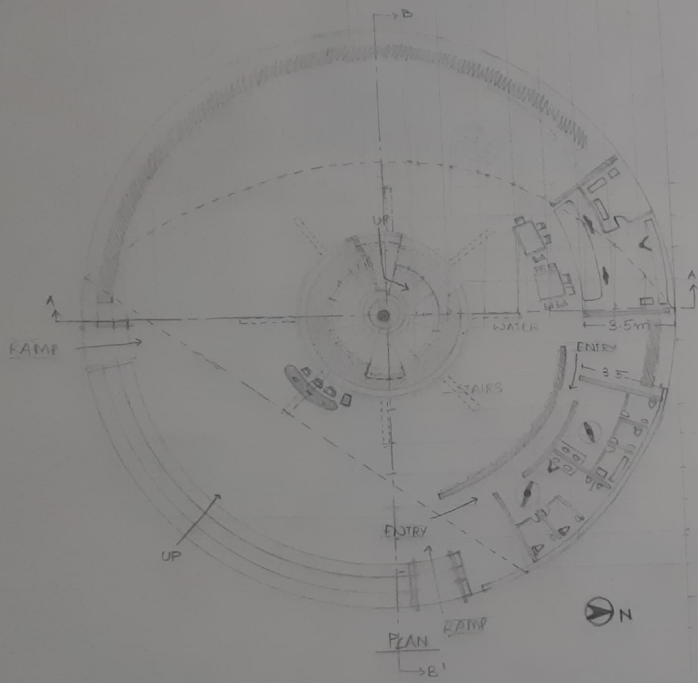

floor in compression  
 Dome in compression  
 Hence the dome can hold the floor

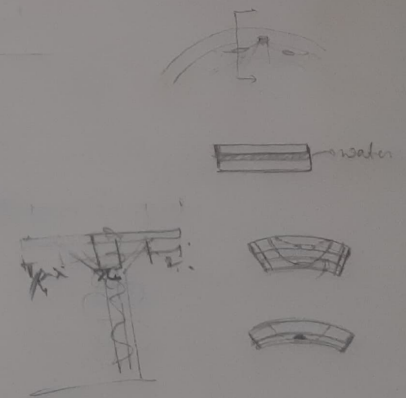

Issues Faced:  
 - rain coming around  
 - toilet not worked properly (standing) as all toilet can fit  
 - roof of the toilet as there will be only depression water only above the toilet  
 - passage of walking into toilets  
 - views inside the toilet

- SITE PLAN  
 → main Road  
 → Gate/Entry  
 → Walkways walkways

DOME: Glass fiber reinforced concrete (GFRC)

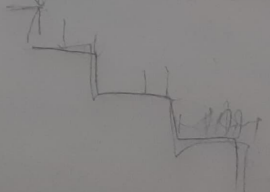

$$2R + 7 = 600$$

$$2R + 400 = 600$$

$$2R = 200$$

$$R = 100$$

# ART GALLERY SITE PLAN

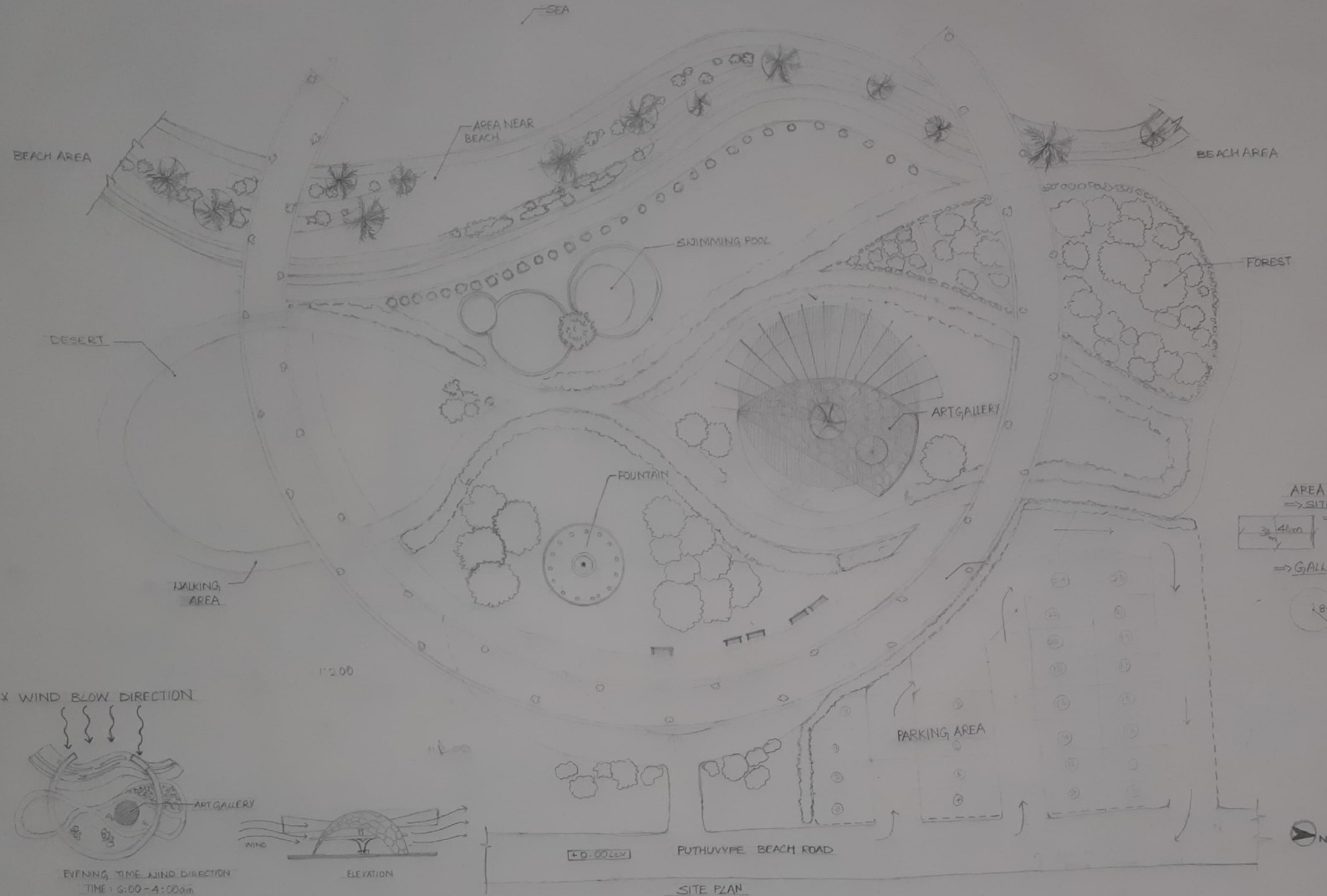

AREA CALCULATION  
 ⇒ SITE AREA  
 $48 \times 38 = 1824 \text{ sqm}$   
 ⇒ GALLERY AREA  
 $\pi r^2 = 3.14 \times 8^2$   
 $\Rightarrow 200.96 \text{ sqm}$

X WIND BLOW DIRECTION

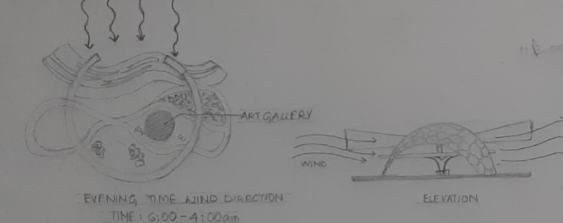

MORNING TIME WIND DIRECTION

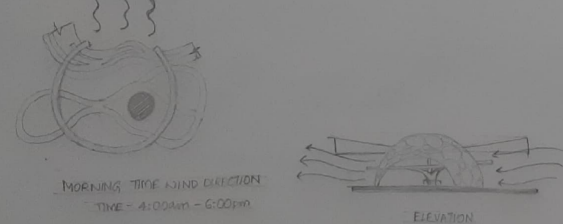

SUN DIRECTION

